

ISP DATA SERVICE ACCESS INSTRUCTIONS

The [IEA Statistics Package](#) contains the following data services:

IEA Statistics package	
12 months' access - (includes any updates during the term)	
Includes databases below:	
World Energy Statistics	Projections - Energy policies of OECD countries
World Energy Balances	Energy Projections of IEA Countries – with
Coal Information	Extended Transitions Indicators
Electricity Information	Energy Prices containing
Natural Gas Information	OECD Energy Prices & Taxes (Quarterly)
Oil Information	Monthly Prices
Renewables Information	World Energy Prices
Greenhouse Gas Emissions from Energy	IEA Energy and Carbon Tracker
Energy End-uses and Efficiency Indicators	Energy Technology RD&D

Important note: our webstore and data service portal do not work on IE. We recommend you use Chrome.

Log into your IEA account by clicking on the profile button:

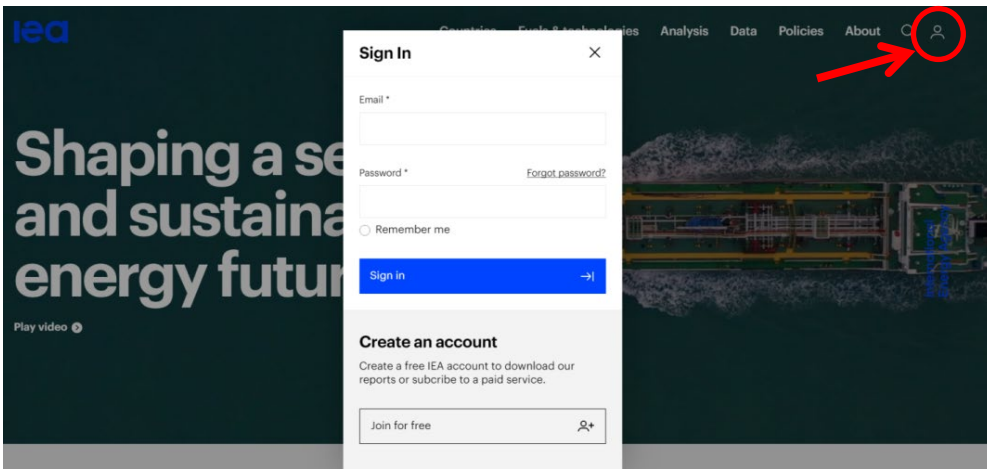

Once you have logged in you need to go to [Products](#) to access the data.

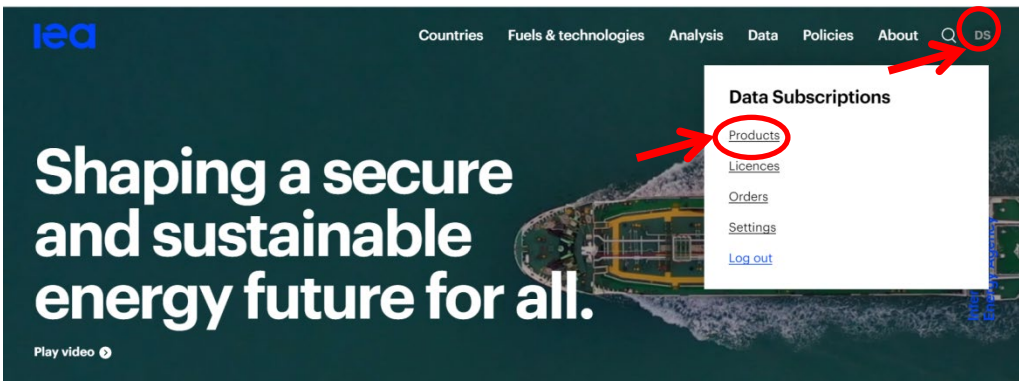

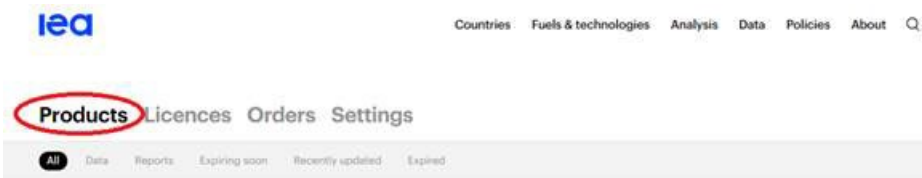

You can download the data sets directly from the website by clicking on the buttons **Download** or **View data sets**, or you can access using the WDS portal (**Access on WDS**).

See screenshot example below:

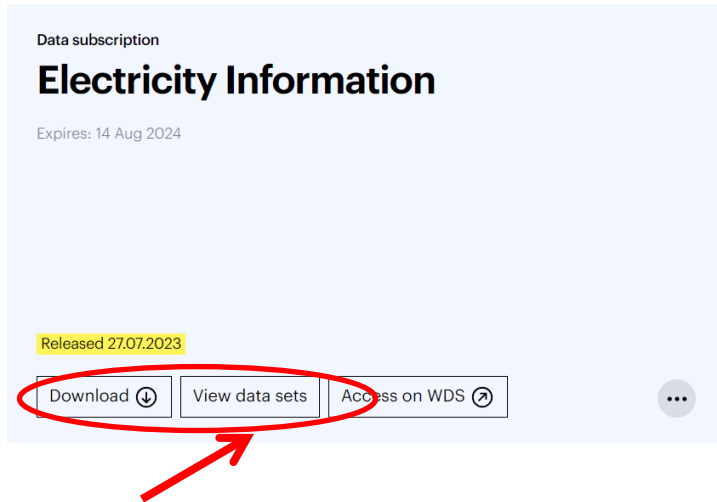

When you click on “**Download**” or “**View data sets**” you will be able to download the database in TXT, IVT or Excel (depending on the data set and availability). More information on IVT format is available further down.

Access over the WDS portal (Web Data Service)

Please note that the IEA Energy and Carbon Tracker is **not** available on the WDS portal but can be accessed over the website directly from “Products” in your account.

To use the WDS portal click on “**Access on WDS**” – see screenshot example below:

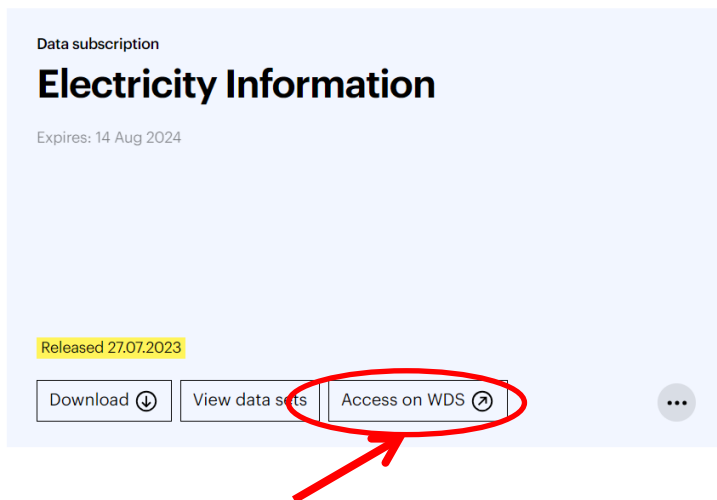

Then click on the report in the left column you are interested in and then the data sets will appear on the right. The free data sets are preceded with orange folder icons; for the paying data sets there will be a

star next to those you have subscribed to. (Note that the Monthly Gas Data Service is not included in the ISP). See screenshot below:

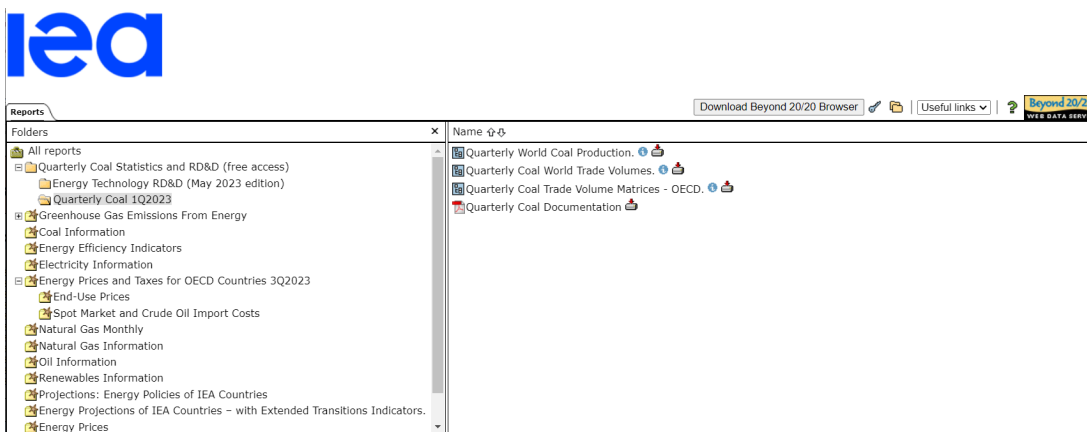

Note that there are **2 ways to access the data on the WDS portal** - you can either view online and just download the data points you are interested in or download the full data sets.

1) Show Table (online)

Click on the database in the left column to see the corresponding data sets on the right. Then click on the required data set (see below):

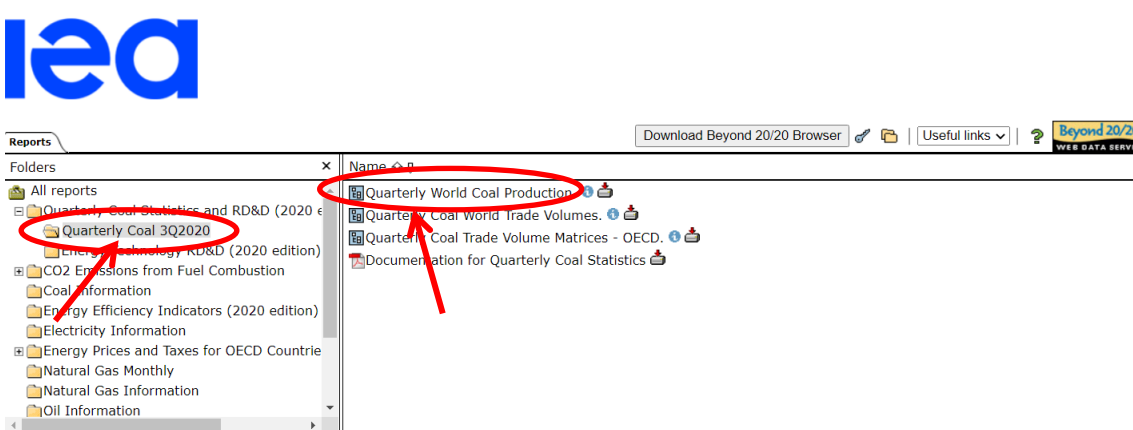

Then select each of the dimensions and the elements you need:

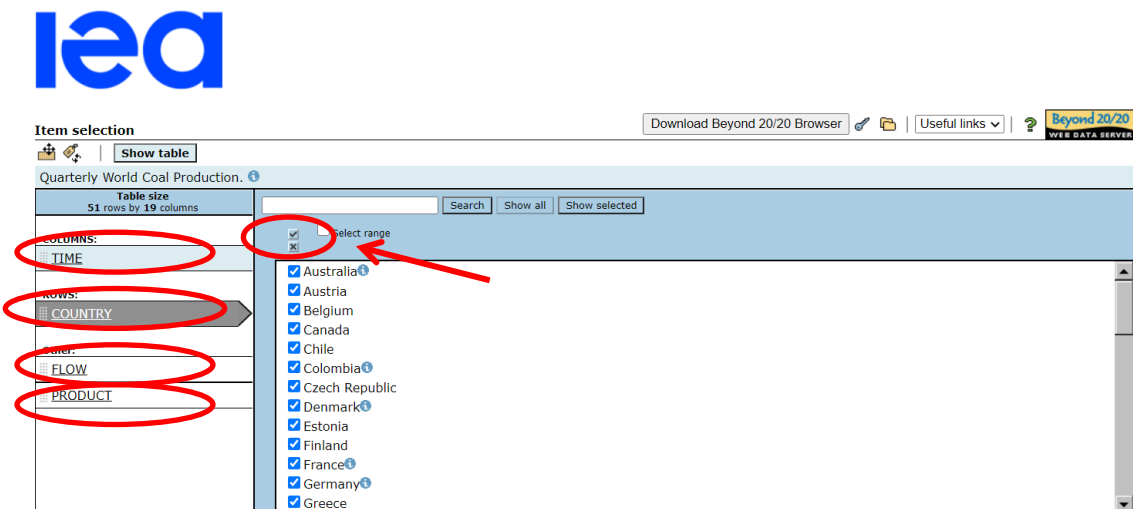

Once you have selected the data you need, click on **Show Table**.

Item selection Download Beyond 20/20 Browser | Useful links | Beyond 20/20 WEB DATA SERVER

Quarterly World Coal Production. Search Show all Show selected

Table size: 51 rows by 19 columns

COLUMNS: Select range

TIME

ROWS: COUNTRY

Other:

FLOW

PRODUCT

- Australia
- Austria
- Belgium
- Canada
- Chile
- Colombia
- Czech Republic
- Denmark
- Estonia
- Finland
- France
- Germany
- Greece

When you have the table you can arrange it as you wish (see below):

Reports Table Chart Download Beyond 20/20 Browser | Useful links | Beyond 20/20 WEB DATA SERVER

Quarterly World Coal Production. Print setup

Other: FLOW - Production PRODUCT - Steam and Coking Coal (kt)

TIME: 1Q2016, 2Q2016, 3Q2016, 4Q2016, 1Q2017, 2Q2017, 3Q2017, 4Q2017, 1Q2018, 2Q2018, 3Q2018, 4Q2018, 1Q2019, 2Q2019, 3Q2019, 4Q2019, 1Q2020, 2Q2020

COUNTRY: Australia, Chile, Colombia, Czech Republic, Denmark, Estonia, Finland, France, Germany

COUNTRY	1Q2016	2Q2016	3Q2016	4Q2016	1Q2017	2Q2017	3Q2017	4Q2017	1Q2018	2Q2018	3Q2018	4Q2018	1Q2019	2Q2019	3Q2019	4Q2019	1Q2020	2Q2020
Australia	106,912	109,837	109,837	109,837	109,837	109,837	109,837	109,837	109,837	109,837	109,837	109,837	109,837	109,837	109,837	109,837	109,837	109,837
Chile	2,294	15,157	15,226	13,056	12,669	13,271	12,504	13,664	11,930	12,791	13,206	13,492	12,318	12,475	12,393	8,932	7,952	7,952
Colombia	617	682	548	662	456	525	782	613	593	612	439	435	421	375	376	457	449	449
Czech Republic	1,080	23,443	22,438	23,156	22,572	22,568	22,253	21,528	20,008	20,521	22,227	20,977	18,898	20,464	20,005	19,456	9,743	9,743
Denmark	633	1,642	1,667	1,595	1,129	1,223	1,653	1,142	1,002	1,136	1,282	737	846	913	936	627	366	366
Estonia	0	0	0	0	0	0	0	0	0	0	0	0	0	0	0	0	0	0
Finland	0	0	0	0	0	0	0	0	0	0	0	0	0	0	0	0	0	0
France	0	0	0	0	0	0	0	0	0	0	0	0	0	0	0	0	0	0
Germany	1,368	1,220	882	608	1,208	997	970	661	960	942	511	348	0	0	0	0	0	0

Select items to view | Download | Set dimension order | View printable version

Once you have the table arranged as you want, you can download into excel or other format (see below):

Reports Table Chart Download Beyond 20/20 Browser | Useful links | Beyond 20/20 WEB DATA SERVER

Quarterly World Coal Production. Download

Other: FLOW - Production PRODUCT - Steam and Coking Coal (kt)

TIME: 4Q2016, 1Q2017, 2Q2017, 3Q2017, 4Q2017, 1Q2018, 2Q2018, 3Q2018, 4Q2018, 1Q2019, 2Q2019, 3Q2019, 4Q2019, 1Q2020, 2Q2020, 3Q2020, 4Q2020, 1Q2021, 2Q2021, 3Q2021

COUNTRY: unrefined, Austria, Belgium, Colombia, Costa Rica, Czech Republic, Denmark, Estonia, Finland

COUNTRY	4Q2016	1Q2017	2Q2017	3Q2017	4Q2017	1Q2018	2Q2018	3Q2018	4Q2018	1Q2019	2Q2019	3Q2019	4Q2019	1Q2020	2Q2020	3Q2020	4Q2020	1Q2021	2Q2021	3Q2021	
unrefined	106,479	109,313	114,453	114,283	109,042	105,574	111,396	110,030	109,608	118,868	111,263	117,567	111,770	119,854	114,801	116,082	107,110	113,275	106,527	102,542	99,353
Austria	0	0	0	0	0	0	0	0	0	0	0	0	0	0	0	0	0	0	0	0	0
Belgium	37	37	37	16	16	38	29	38	35	35	35	38	45	35	35	34	28	41	41	44	113
Colombia	89	12,830	12,897	13,251	12,858	13,469	12,690	12,606	11,006	11,800	12,183	11,988	10,945	11,085	11,013	9,997	8,901	8,915	10,794	10,294	10,397
Costa Rica	17	682	548	662	456	525	782	613	593	612	439	386	374	333	334	469	0	2	8	11	5
Czech Republic	2,073	1,633	1,642	1,667	1,595	1,129	1,223	1,653	1,142	1,002	1,136	1,282	764	873	940	963	628	384	268	920	888
Denmark	0	0	0	0	0	0	0	0	0	0	0	0	0	0	0	0	0	0	0	0	0
Estonia	0	0	0	0	0	0	0	0	0	0	0	0	0	0	0	0	0	0	0	0	0
Finland	0	0	0	0	0	0	0	0	0	0	0	0	0	0	0	0	0	0	0	0	0

Note: in this case there is a limitation of 50 000 cells per download.

OR

2) Download full databases (and work offline)

Step 1: Download and install the Beyond 20/20 browser software onto your computer.

You should download it directly from the website before trying to access the data for the first time. To download, click on the button in the upper right-hand corner of the screen that says "Download Beyond 20/20 Browser".

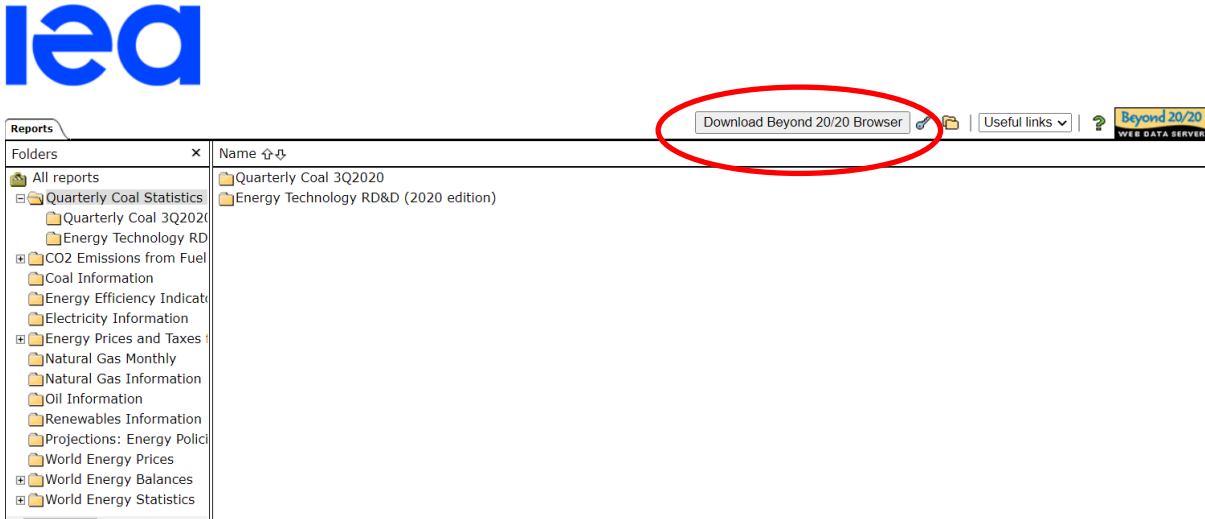

Step 2: Download the data files in .IVT format.

Highlight the folder in the left-hand column. There should be a gold star on the folder icon showing that you have access to that on-line data service.

To download individual data files, click on the little box with the red arrow to the right of each data file in the right-hand column. All the files should be downloaded into the same directory for ease of use. Documentation can also be downloaded in PDF format.

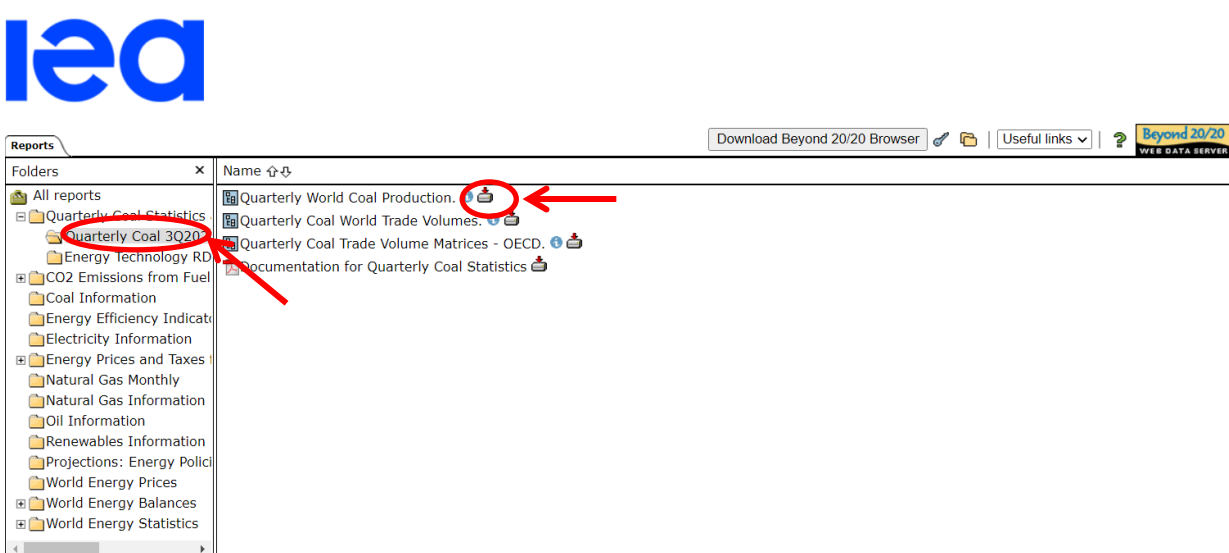

Portions of the IEA Online Data services include technology used under license from Beyond 20/20 Inc. and in which Beyond 20/20 Inc. and/or its licensors retain copyright. Your use of these services is subject to the Beyond 20/20's [License Agreement](#). You must not remove any proprietary notices or labels on the Beyond 20/20 Inc. software. Source: IEA. All rights reserved.

Once you have downloaded the IVTs you can save as Excel, CSV, TXT etc. by clicking on File, Save As...

	3Q2016	4Q2016
397	104,966	11
0	0	
4	4	
294	13,157	1
517	682	
380	23,443	2
333	1,642	
0	0	
0	0	
0	0	
0	0	
0	0	
220	882	
0	0	
0	0	
0	0	
0	0	
0	0	
321	322	
136	416	

Step 3: Once the software and data files are downloaded, you no longer need to use the internet. Open the data files using the software and work off-line.

Note: As explained above you can also access the data over the internet by clicking on the **Show Table** icon but it is much more efficient to access the data as described above. **However if you wish to access the data over the internet please make sure that you download the full databases onto your computer before the expiry dates (Step 2).**